

# Model 42B Ribbon Blender Specifications and Dimensions

## STANDARD FEATURES:

- 1 through 1000 cubic foot capacity
- Stainless steel 304 wetted parts
- Ribbon agitator for center discharge
- Designed for atmospheric operation
- 60 grit finish on interior and exterior stainless steel surfaces
- One, two or three-piece blender cover with silicon gaskets
- Clamps to reduce dust and fume migration between cover and trough
- NEMA 12 safety limit switches prevent operation of the agitator when cover is raised
- Stuffing boxes with easily disassembled split housing
- Teflon braided packing
- Manually operated knife gate discharge valve
- All exterior non-stainless steel surfaces are painted with a white, two-part epoxy coating
- 230/460 volt, 60 Hz, three phase TEFC motor
- Blender is mounted on supports providing a discharge clearance of 36"
- Suitable for product densities up to 35 pounds per cubic foot

## OPTIONAL FEATURES:

- Pneumatically operated knife gate discharge valve
- Spray nozzles for liquid introduction
- Control options include variable frequency drives, motor starters and operator stations



**CHARLES ROSS & SON COMPANY**

P.O. Box 12308, 710 Old Willets Path, Hauppauge, NY 11788

Phone: 631-234-0500 • Fax: 631-234-0691

Website: [www.mixers.com](http://www.mixers.com) • E-mail: [sales@mixers.com](mailto:sales@mixers.com)

# Model 42B Ribbon Blender Specifications and Dimensions

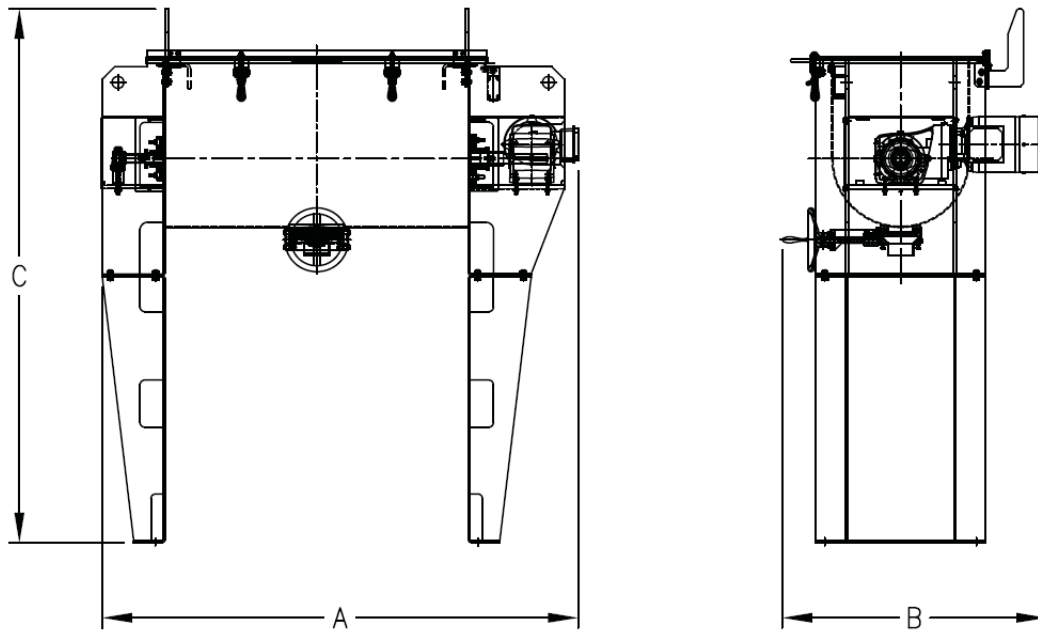

Model Number	Working Capacity		Full Capacity		Motor HP	Agitator RPM	Trough Size (inches)			Overall Dimensions (inches)			Shipping Weight (lbs)
	cu.ft.	gal	cu.ft.	gal			Width	Length	Depth	A	B	C	
42B-1	1	7	1.3	9	1/2	99	12	20	14	43	26	53	700
42B-5	5	37	7	52	1 1/2	66	13	38	21	67	34	68	1000
42B-10	10	74	13	94	3	56	21	48	25	89	39	72	1600
42B-18	18	134	22	165	5	47	24	60	29	95	42	79	2650
42B-25	25	187	30	224	7 1/2	43	29	60	33	95	46	81	3000
42B-36	36	269	41	307	10	40	30	78	34	115	49	92	3400
42B-52	52	388	56	424	15	37	34	84	38	122	52	92	4500
42B-62.5	62.5	465	72	540	20	32	36	96	40	144	66	97	5000
42B-71	71	530	80	598	20	30	38	96	42	149	66	99	5500
42B-80	80	598	90	673	20	28	38	108	42	158	66	99	6000
42B-100	100	748	110	825	25	28	40	120	44	177	72	101	7000
42B-120	120	897	132	988	30	25	44	120	48	179	72	104	8000
42B-155	155	1159	168	1263	40	24	50	120	54	185	78	112	12500
42B-180	180	1345	195	1459	Per application	23	50	120	58	189	85	120	13200
42B-215	215	1610	235	1756		20	54	144	58	193	85	125	14000
42B-270	270	2017	300	2241		20	54	144	66	195	104	129	17000
42B-325	325	2427	355	2651		15	72	144	72	201	123	132	22000
42B-385	385	2876	425	3175		15	72	144	78	207	130	137	26000
42B-515	515	3847	565	4220		15	72	197	78	260	130	137	30000
42B-600	600	4488	680	5087		13	84	158	93	225	139	121	N/A
42B-800	800	5984	900	6732		12	93	170	103	238	158	133	N/A
42B-1000	1000	7481	1120	8378		11	97	177	111	256	169	142	N/A